



OWNERS MANUAL

MODEL PR01



○ **Structure characteristic**

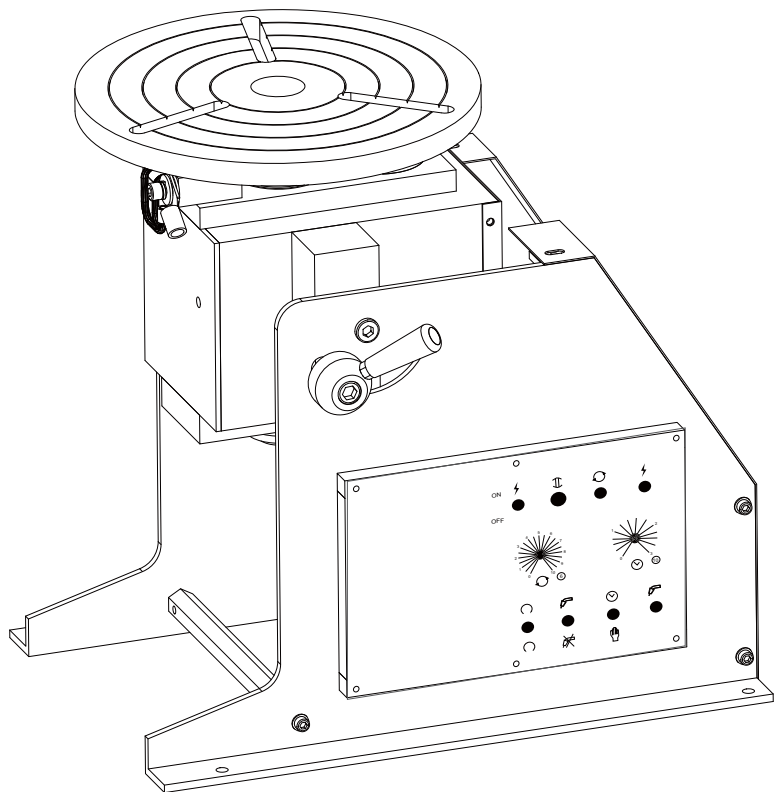

○ **Welding method that can be matched**

- MIG/MAG
- TIG
- Wire-TIG
- Plasma weld
- SAW

○ **Dispose the place**

- In the factory

○ **Duty cycle**

- Can operate in succession 100%
- Weld electric current 300A

• **Installation**

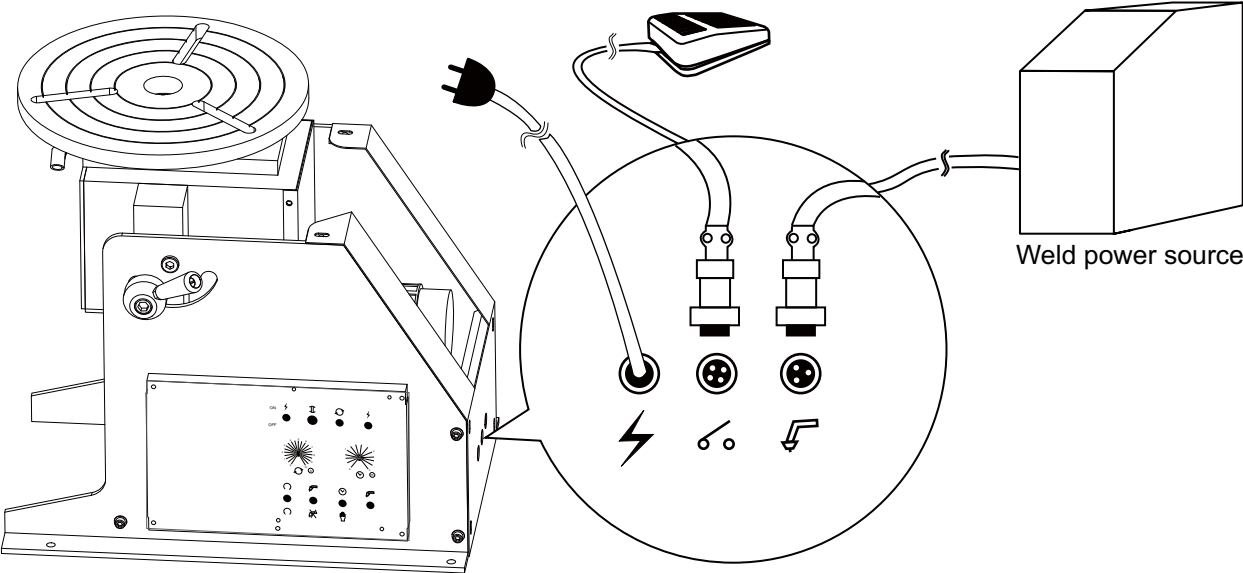

○ The PR01 controller panel of the standard turn table is explained

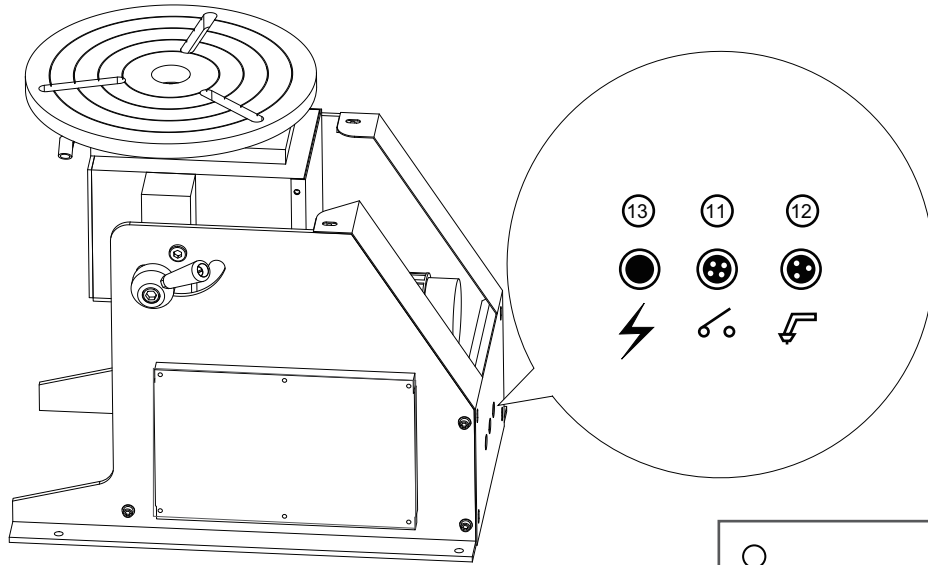

- 1. Power switch
- 2. Power light
- 3. Table light
- 4. Welder light
- 5. FUSE
- 6. Table speed (RPM)
- 7. Table cw/ccw switch

- 8. Welder switch
- 9. Auto / Inch switch
- 10. Timer
- 11. Start switch socket(2P)
- 12. Welder switch socket(3P)
- 13. Power

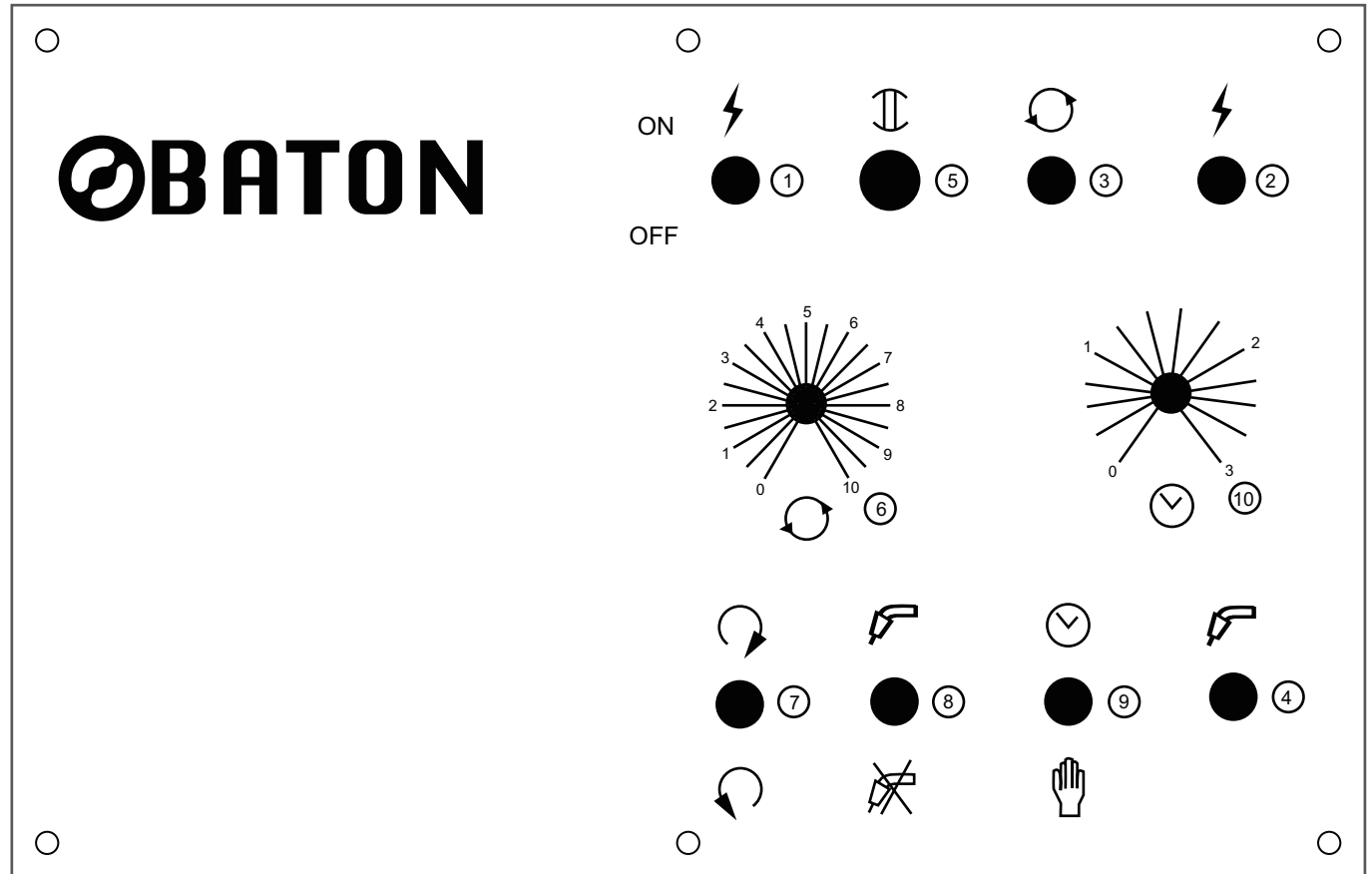
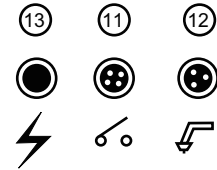

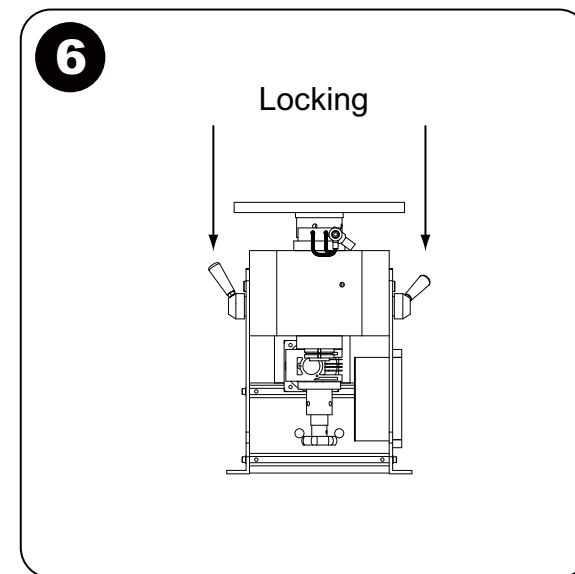
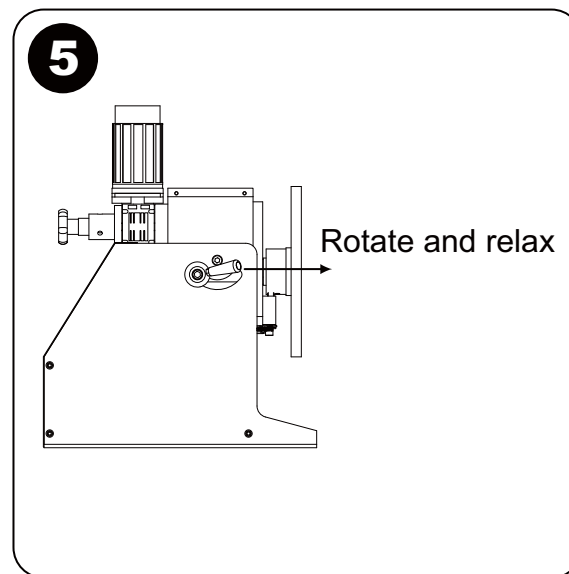
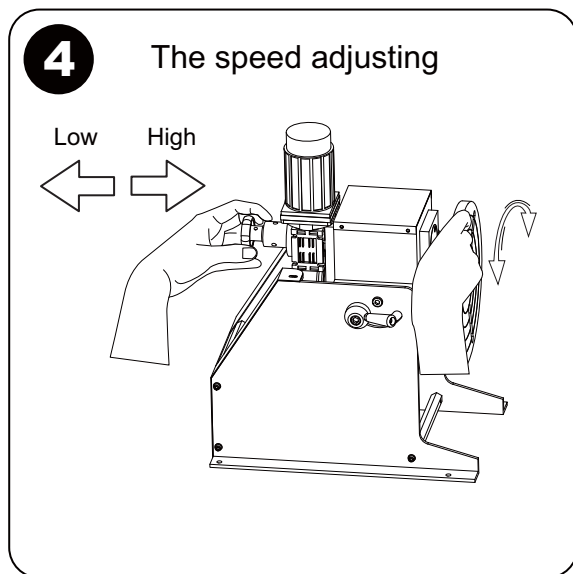
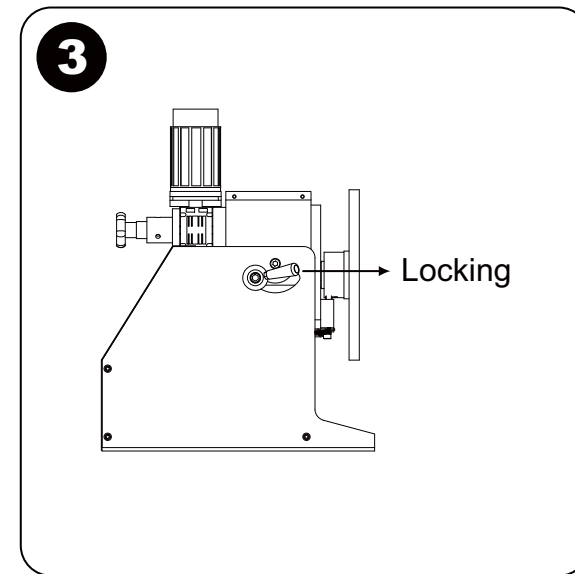
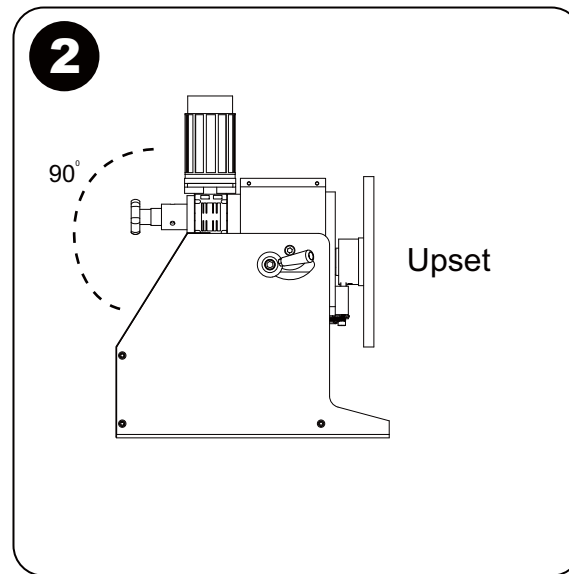
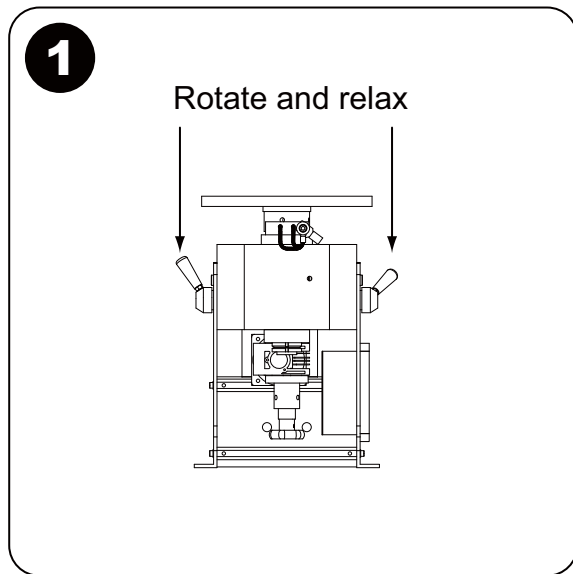

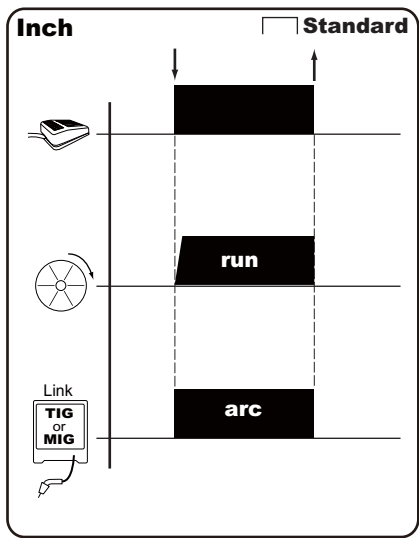

1

ON

①

Power switch on

OFF

②

Light

2

⑨

Inch switch to down

3

⑧

Welder switch to up

4

⑦ or ⑦

Rotate the direction cw/ccw

5

Rotate speed (RPM)

6

Start switch

Table and welder off

8

Stop switch

Table and welder on

7

④

Light

③

Light

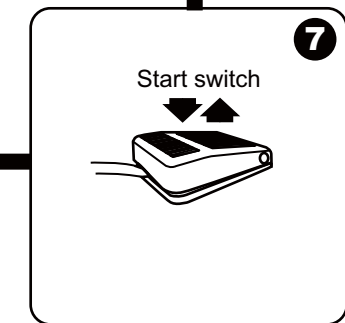
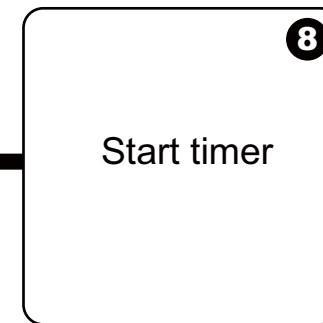
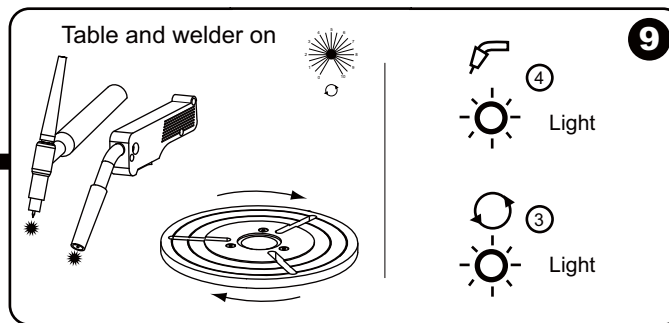
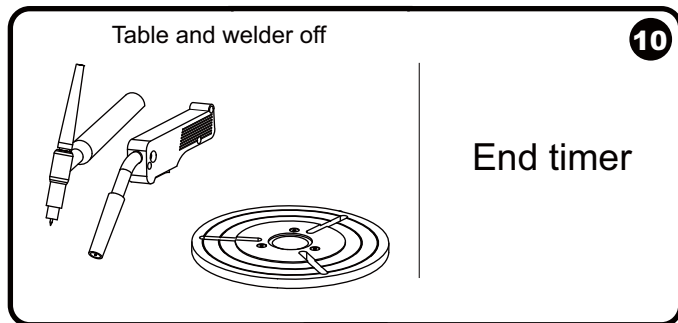
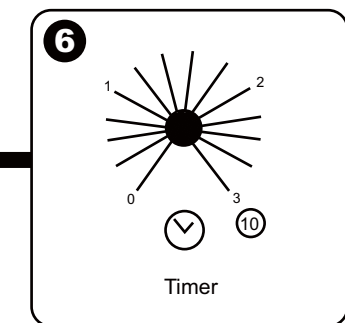
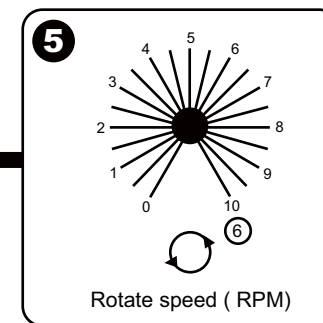
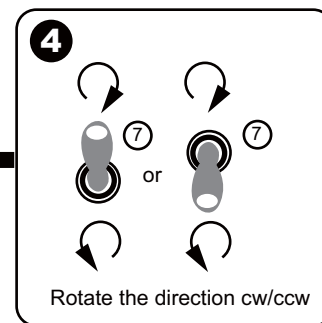
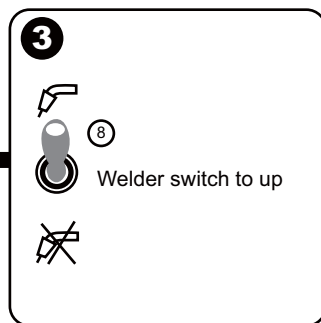
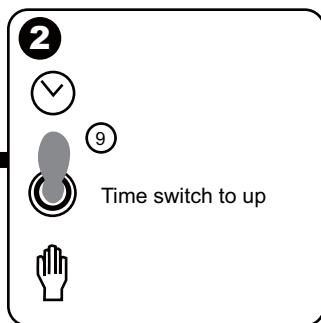
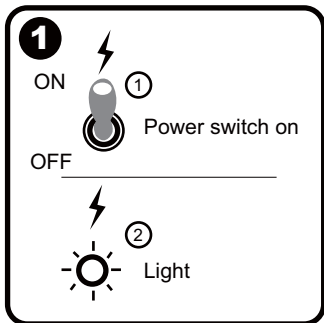
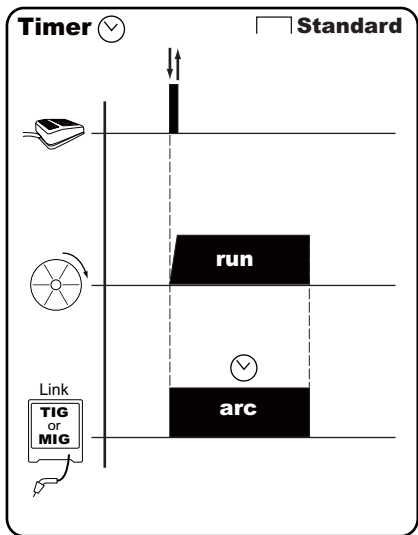

○ **Table start and accelerate time to adjust**

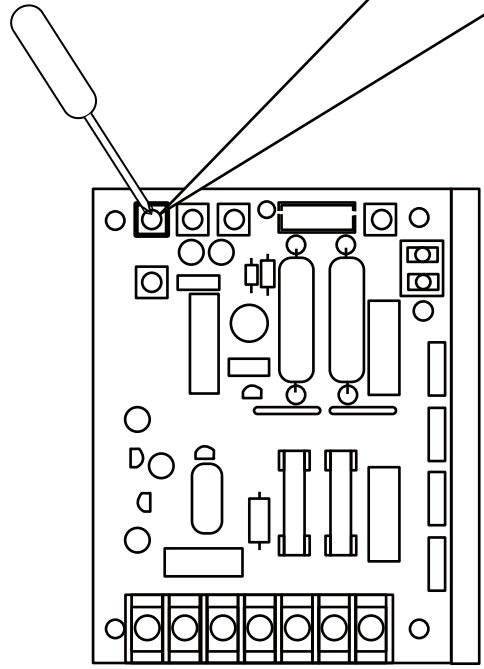
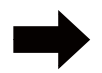
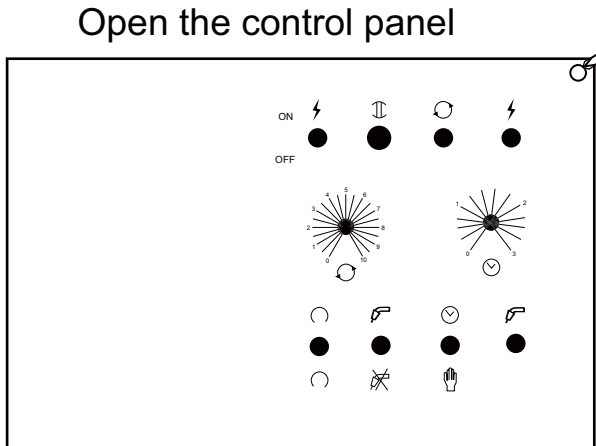
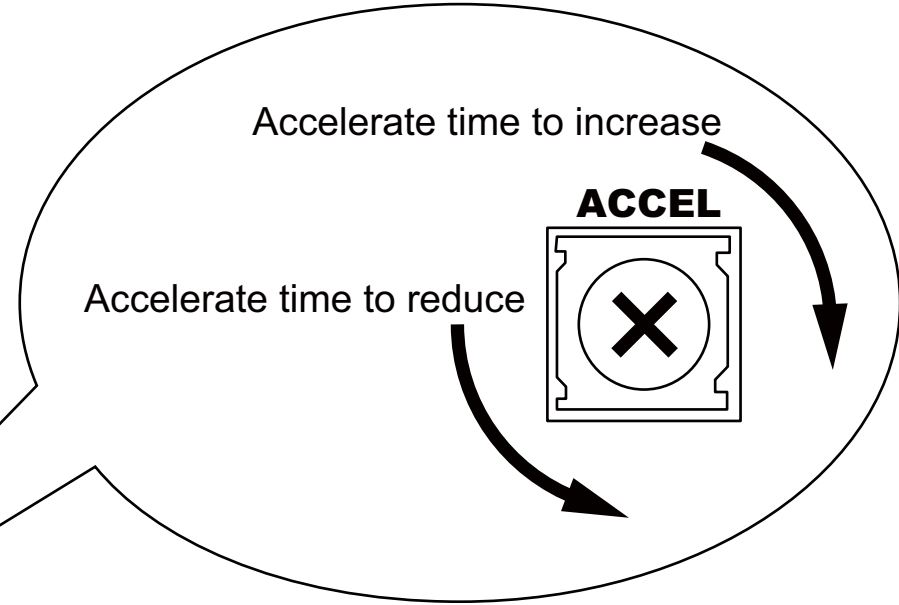
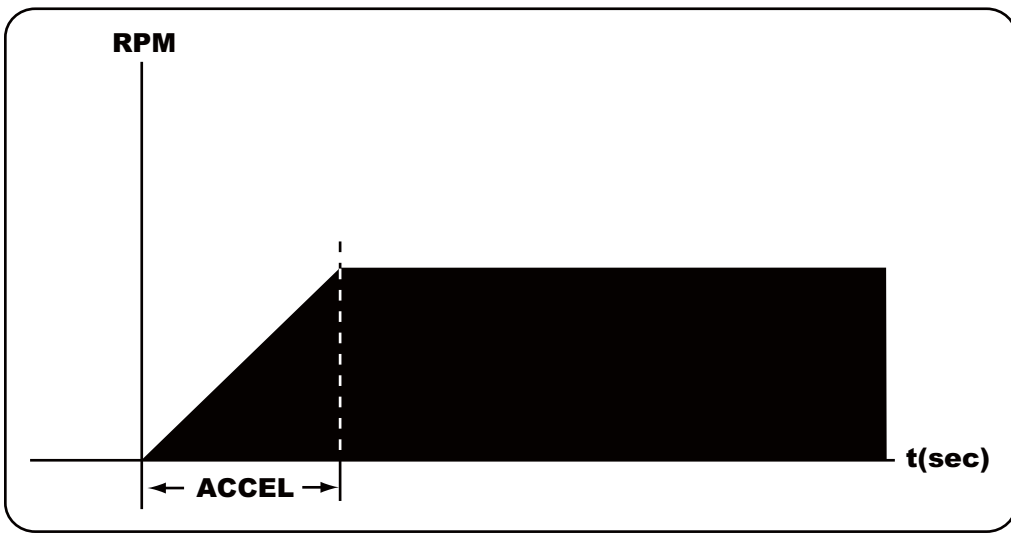

DC motor driver

○The time of the timer range adjusting

Open the control panel

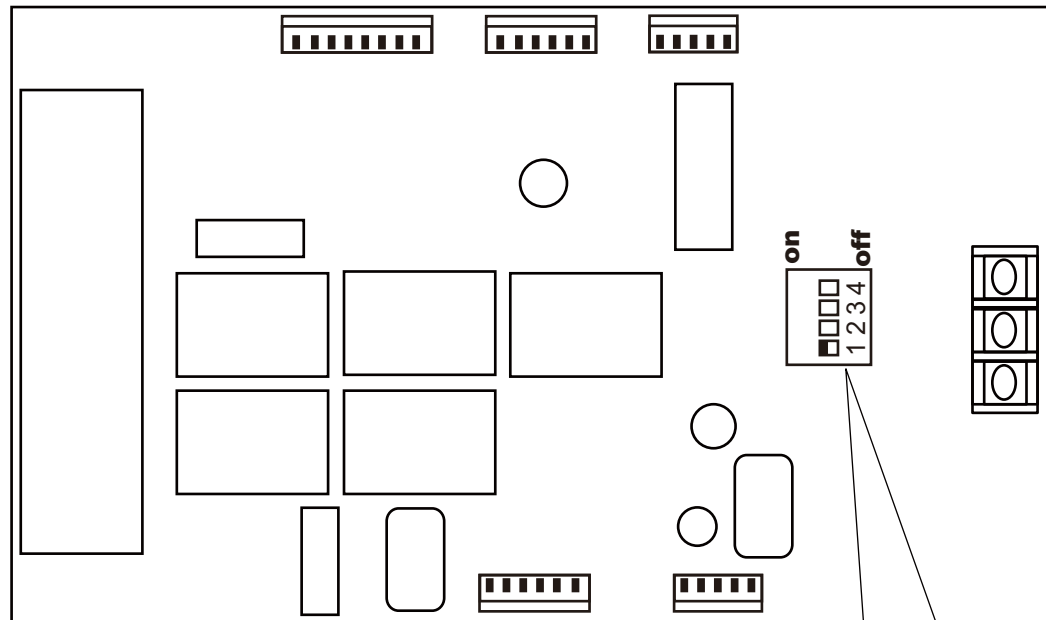
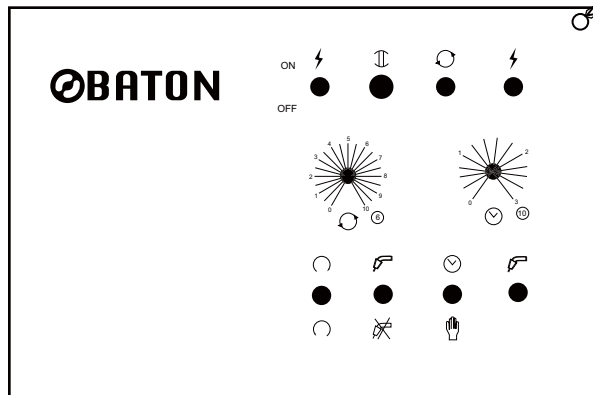

	SW1	SW2	SW3	SW4
8秒	ON	OFF	ON	OFF
30秒	OFF	ON	ON	OFF
60秒	OFF	ON	ON	ON
180秒	OFF	OFF	OFF	OFF
240秒	ON	ON	ON	OFF

•Warn the item

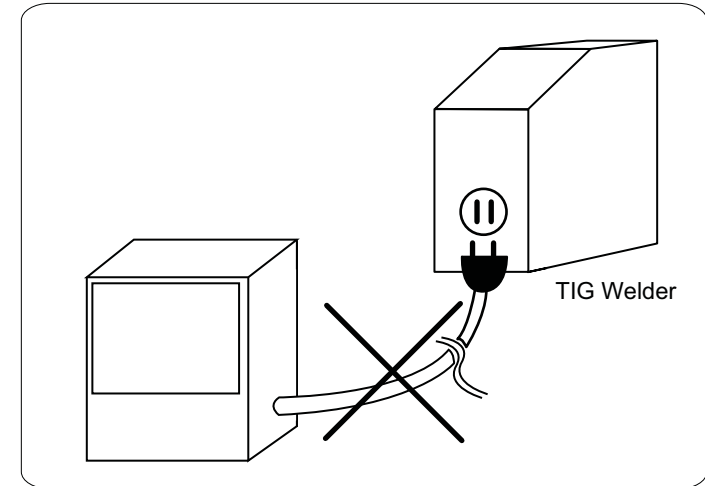
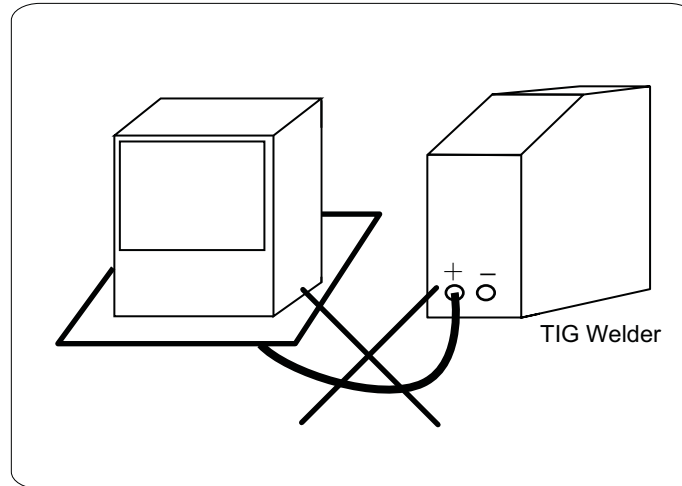
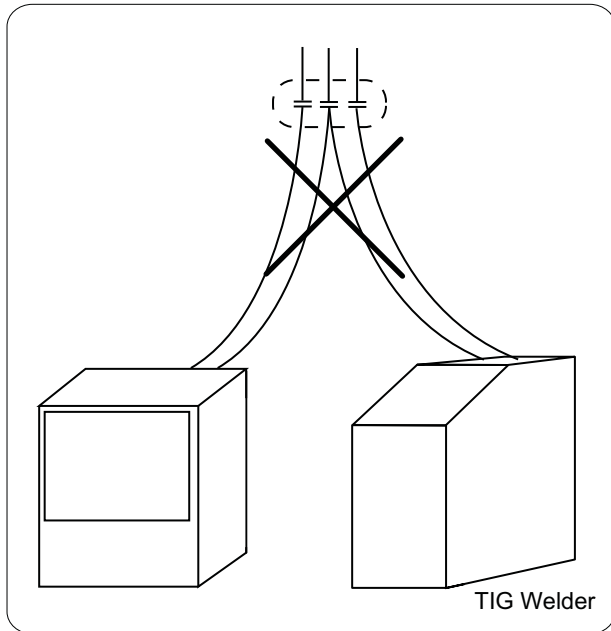
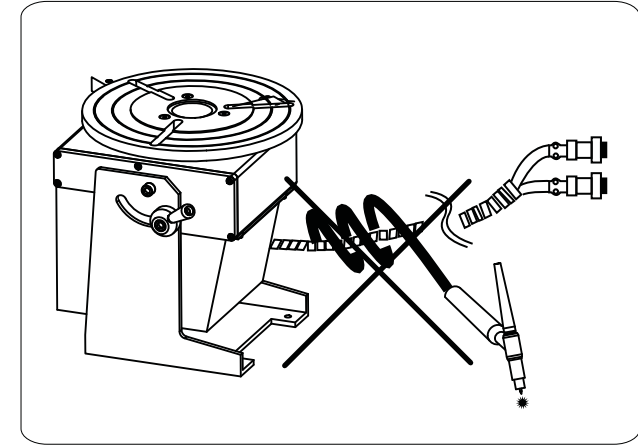
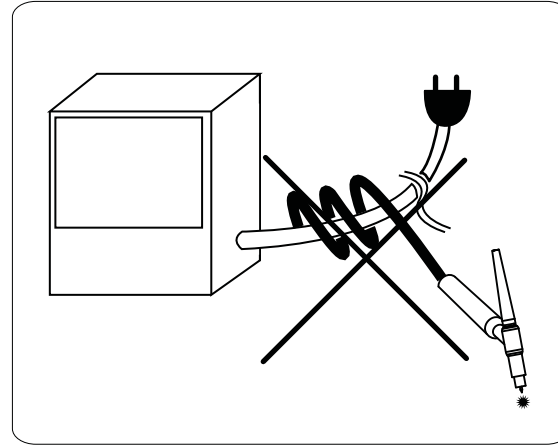
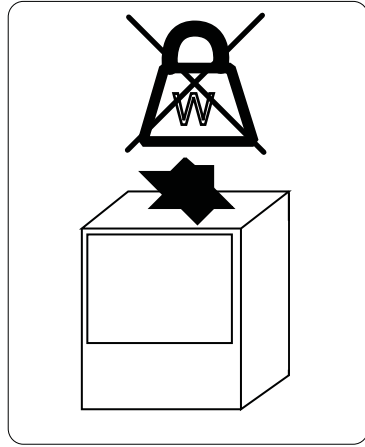
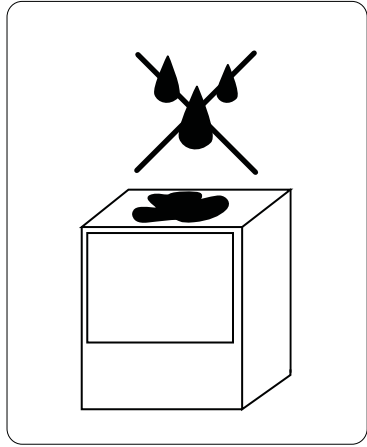

1

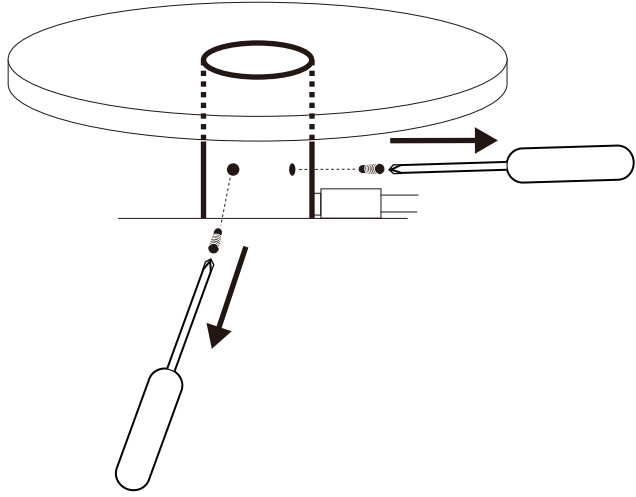

2

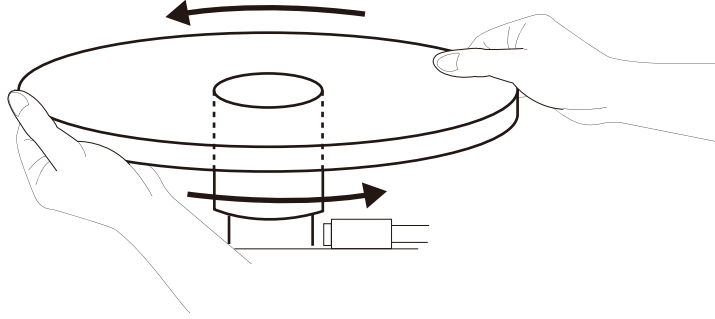

3

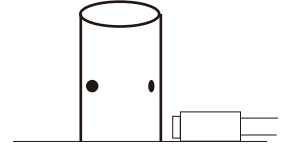

4

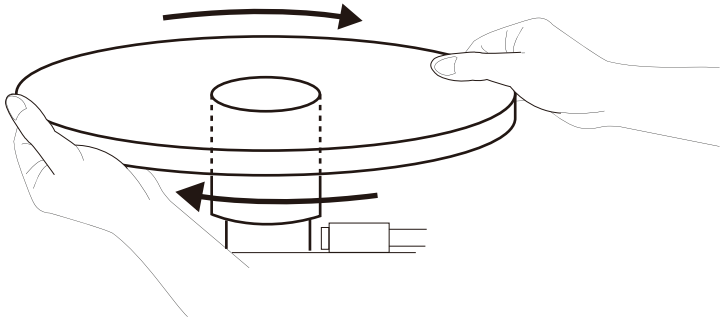

5

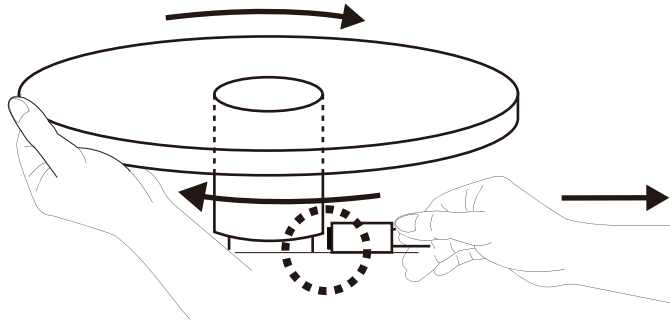

6

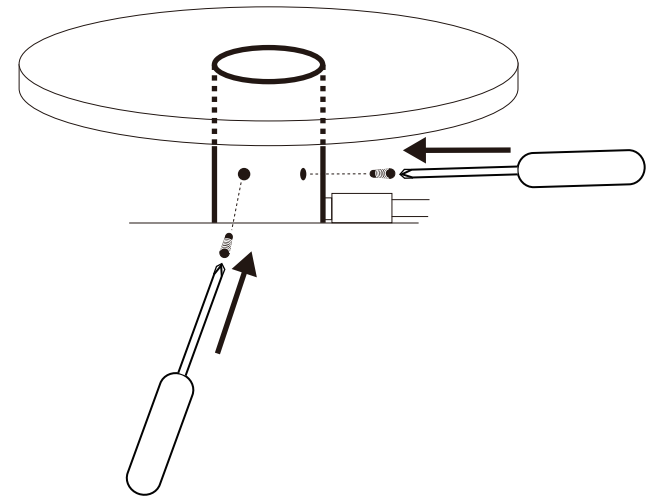

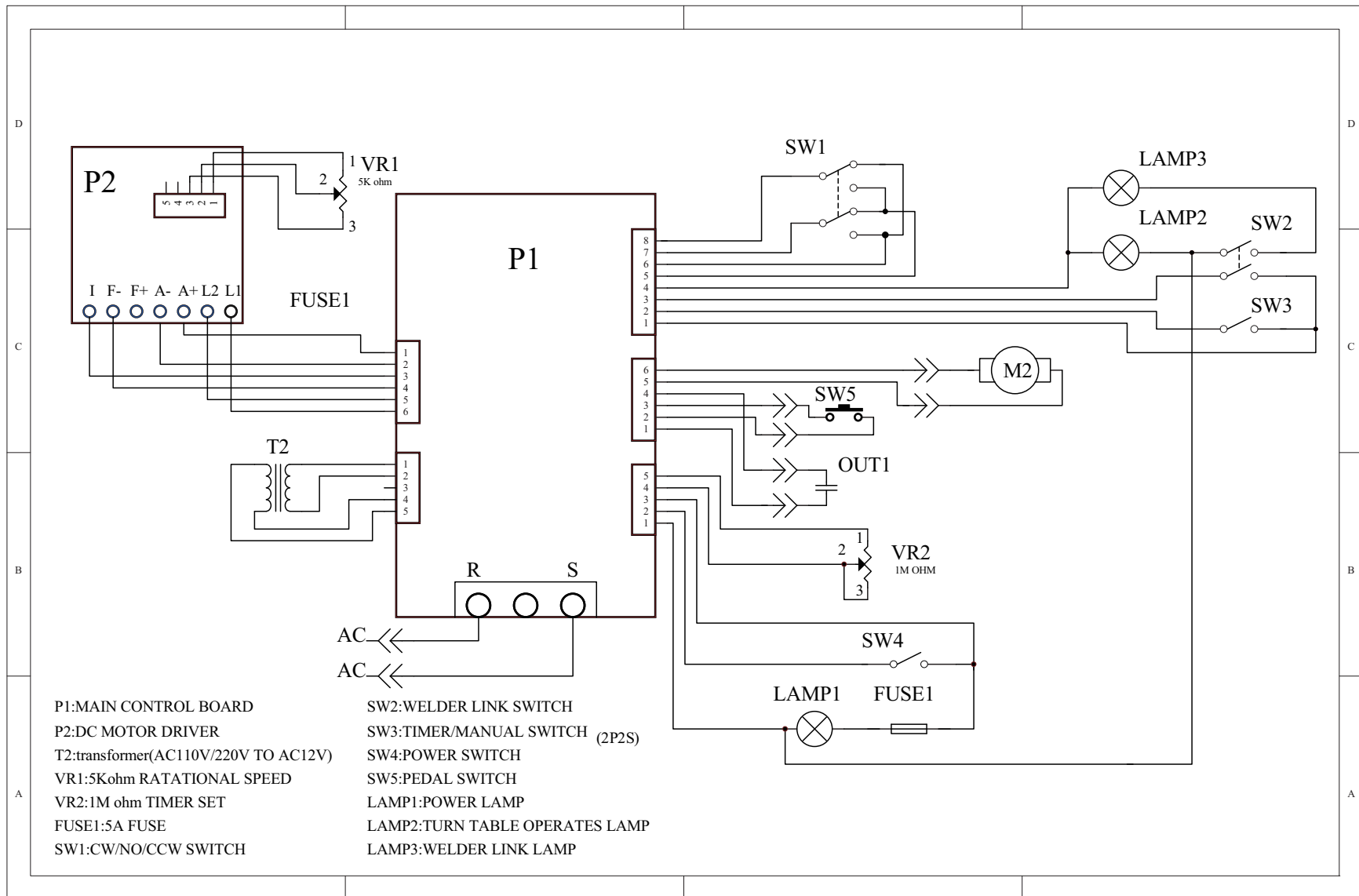

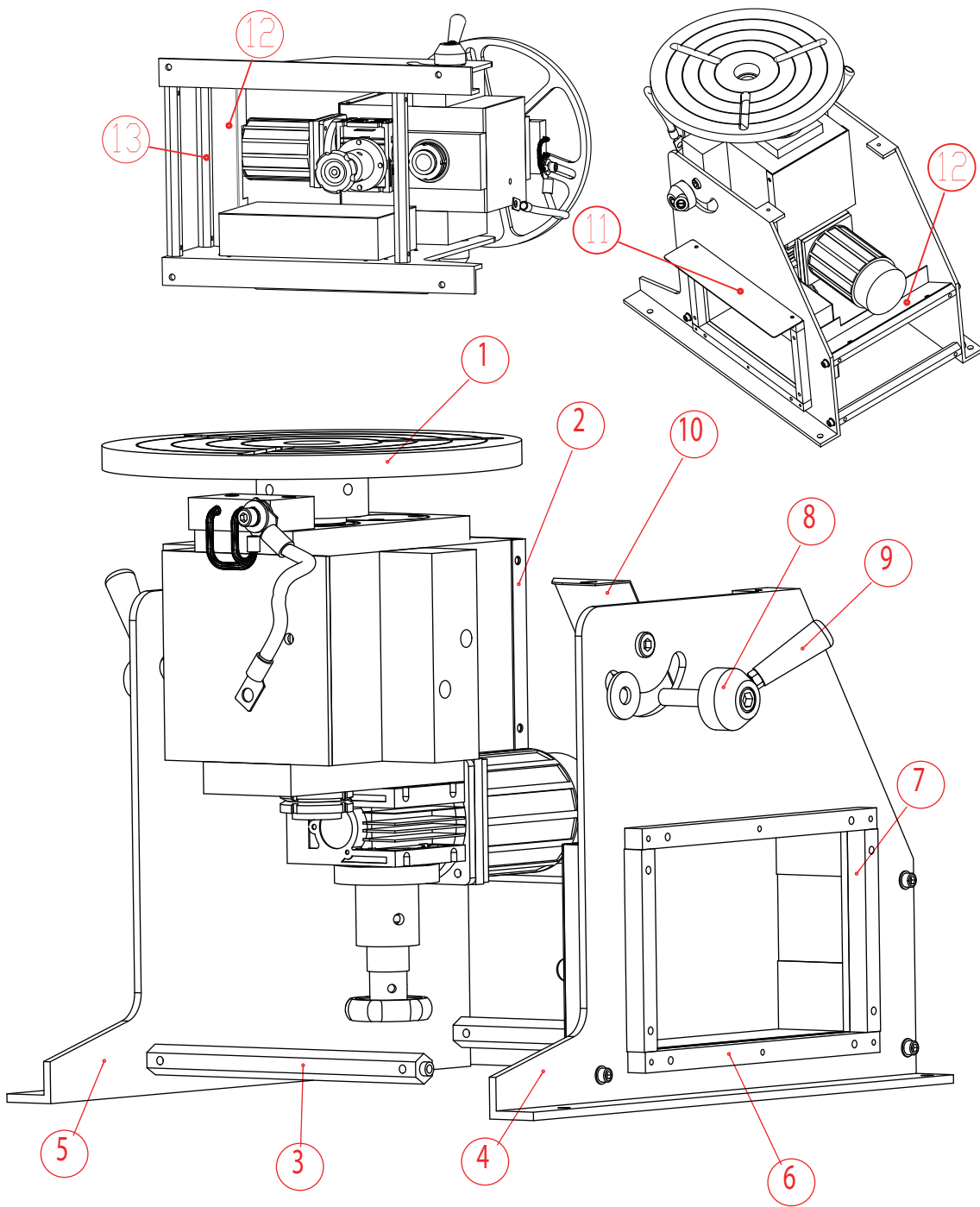

Item	Part No.	Part Name	Q'TY
1	POS08VS-1	Table case group	1
2	POS08VS-18	Cover	1
3	POS08VS-13	Combine pole	3
4	POS08VS-12	Base shelf	1
5	POS08VS-11	Base shelf	1
6	POS08VS-15	Long insulating board	2
7	POS08VS-16	Short insulating board	2
8	P1006	Angle fixed screw	2
9	PH-W5/16	Handle	2
10	POS08VS-14	Cover	1
11	POS08VS-17	Control box separator	1
12	POS08VS-16	Body shroud	1
13	POS08VS-13	After connecting column	1

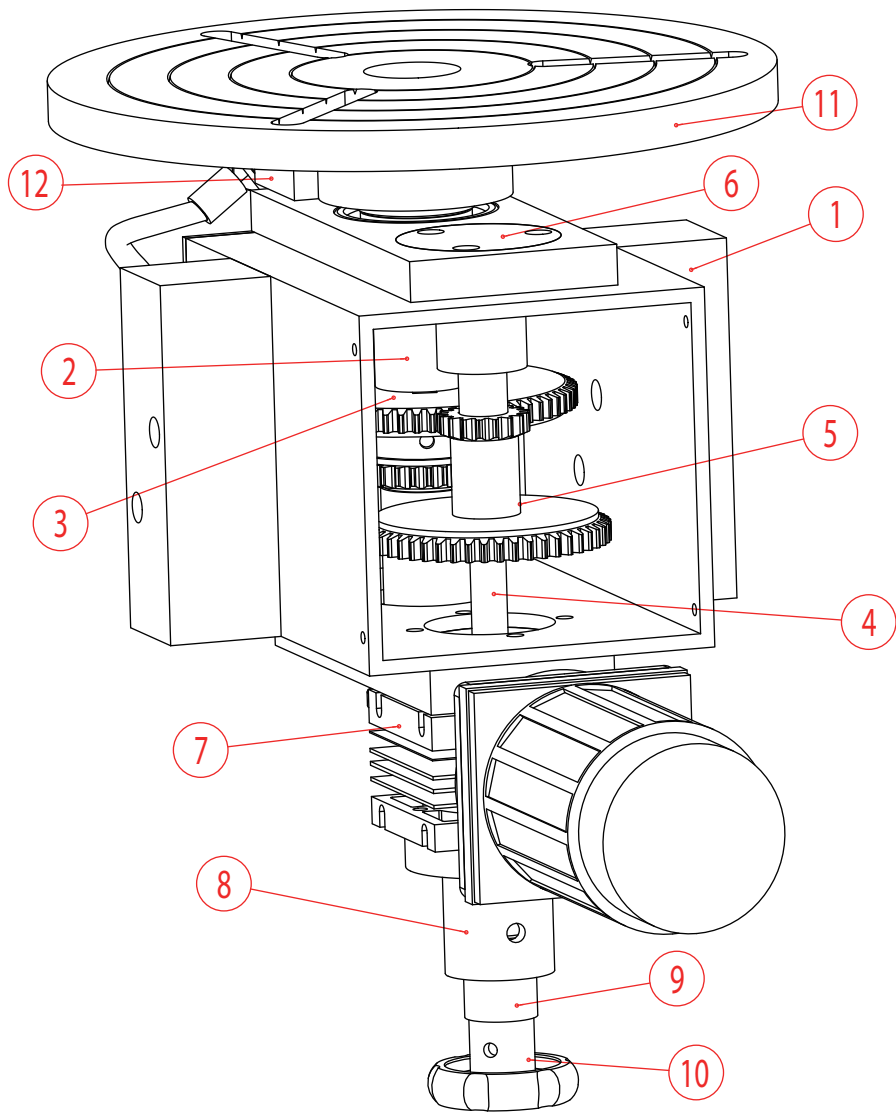

Item	Part Name	Part No.	Quantity
1	Table case	POS08VS-01	1
2	Table axis group	POS08VS-02	1
3	Table gear	POS08VS-04	1
4	axle	POS08VS-06	1
5	Gear	POS08VS-05	1
6	seat	POS08VS-07	1
7	Reducing gear box	F032	1
8	Speed setting seat	POS08VS-08	1
9	Speed setting axis	POS08VS-09	1
10	Speed hand	POS08VS-10	1
11	Table	POS08VS-03	1
12	Welding ground	P100A3	1