

# Turnrollers

## Roller Block up to 1200 kg – TR-1200

### Advantages of the modular system

With our TR 1200 small containers and pipes can be positioned easily and circular weld seams can be welded. Due to its low start-up costs the purchase of the TR 1200 will pay off soon. By means of a torch holder, the welding process can be further simplified and the welder can concentrate exclusively on the control of the welding process.



### Features

- Device for turning and positioning containers and cylindrical workpieces.
- Unit in solid steel construction with PU-coated metal rolls.
- Precise speed adjustment via frequency inverter.
- Foot switch for start/stop, 4-cycle operation.
- Switch for cw/ccw rotation.
- Turning knob for infinitely adjustable rotational speed.
- Changeover switch for quick/normal operation.
- Switch with control lamp for readiness for operation.
- HF-protected.

### Scope of delivery:

- 1 Drive unit with control unit (integrated)
- 1 Idler roller
- 1 Foot switch

**Optional:**  
1 Idler roller



Modell	TR-1200 complete
Netzspannung	230 V 50/60 Hz
Netzsicherung	10 Amp
Traglast	1.200 kg
Geschwindigkeit	80 – 1.600 mm/min.
Rollendurchmesser	200 mm
Rollenbreite	50 mm
Werkstückdurchmesser	20 – 800 mm
Maße (L x B x H) mm	520 x 470 x 390
Gewicht (komplett)	56 kg
Artikelnummer	02.30.10.20120 (old: 71821150)

Model	TR-1200 Idler roller
Load capacity	600 kg
Roller diameter	200 mm
Roller width	50 mm
Workpiece diameter	20 – 800 mm
Weight	17 kg
Measur. (L x B x H) mm	450 x 160 x 340
Item no.	02.30.92.00012 (old: 71821150.0010)

# Turnrollers

## Roller Block up to 3 t – SIR

### Perfect girth welds

The SIR series covers many workpiece diameters. The distance between the rolls can be increased or reduced via plug connection. The strong drive unit allows a smooth and continuous turning movement also with low speed.

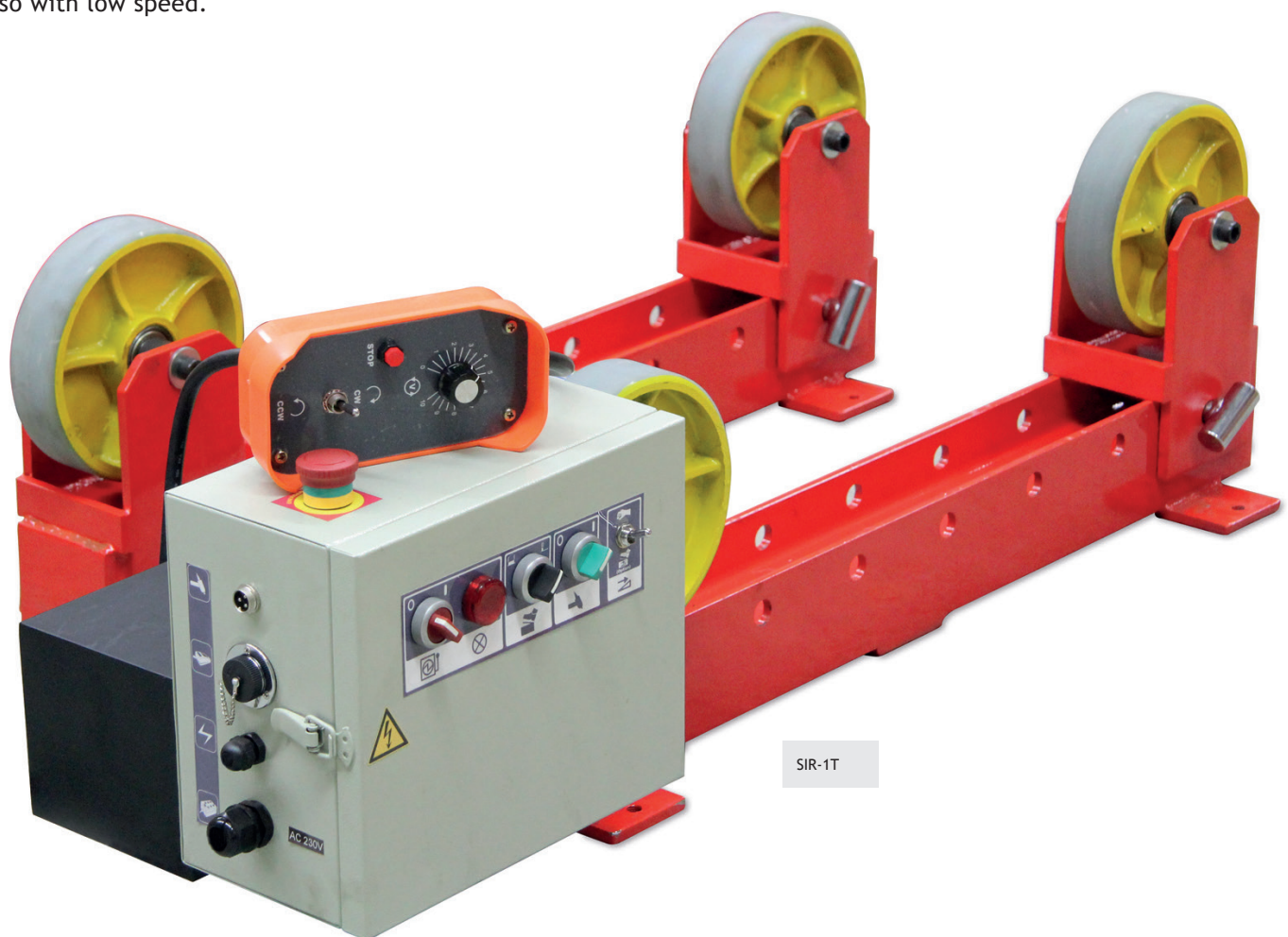

Model	SIR-1T	SIR-3T
Supply voltage	AC 230 V/50 Hz	AC 230 V/50 Hz
Max. load	1 t	3 t
Workpiece diameter	50 – 1.500 mm	150 – 2.000 mm
Roller speed	180 – 1.800 mm/min.	120 – 1.200 mm/min.
Roller size	200 x 50 mm	250 x 75 mm
Max. thermal loading	bis 80° C	bis 80° C
Weight	100 kg	154 kg
Measurements (L x W) mm	950 x 344	1.510 x 250 mm
Item no.	02.30.10.00110 (old: 71821160)	02.30.10.00130 (old: 71821161)

# Turnrollers

## Roller Block up to 3 t – SIR

### Features

- Consisting of drive unit and idler unit.
- Smooth and continuous turning movement also at low speed.
- PU-rollers.
- Container diameter is fast and easily adjustable via plug connection.
- Hand-held remote control (3m) for the adjustment of speed and cw/ccw movement.
- Foot switch.
- Compact and robust design; easy to operate.

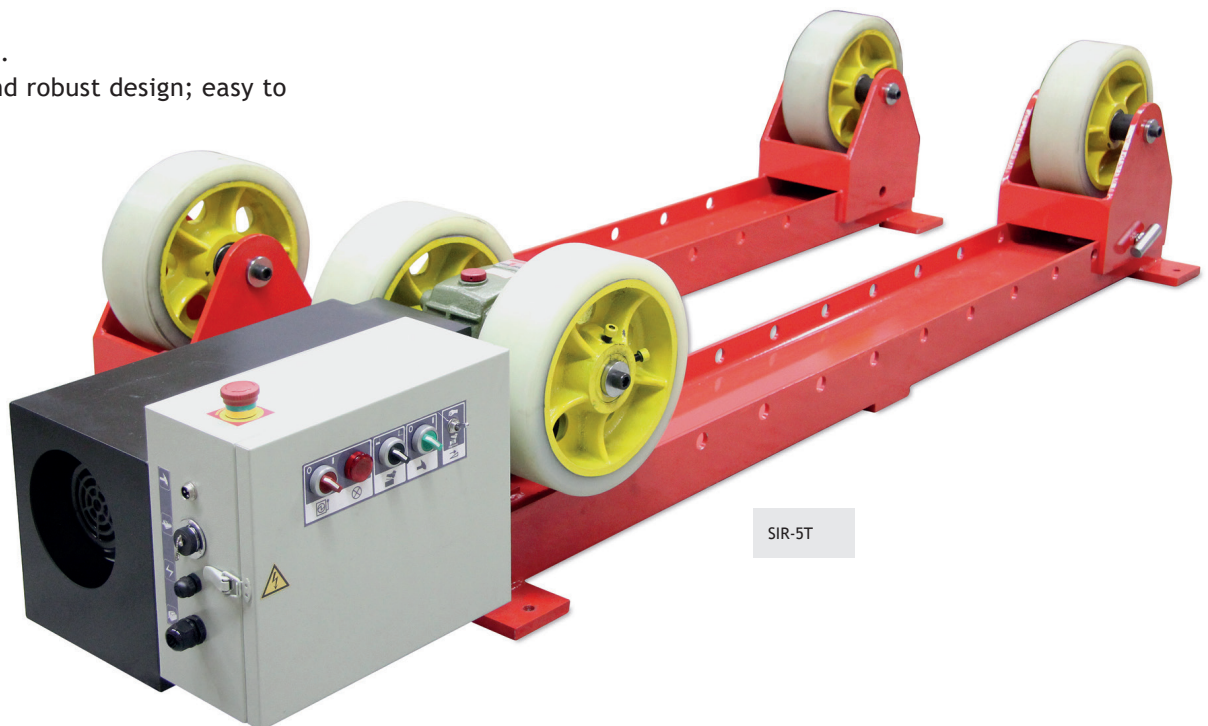

SIR-5T

### Scope of delivery:

- 1 Control unit (integrated)
- 1 Foot switch
- 1 Cable remote control

## Individual Solution

We configure your circular welding unit individually. Just give us a call:

**+497331/3058-0**

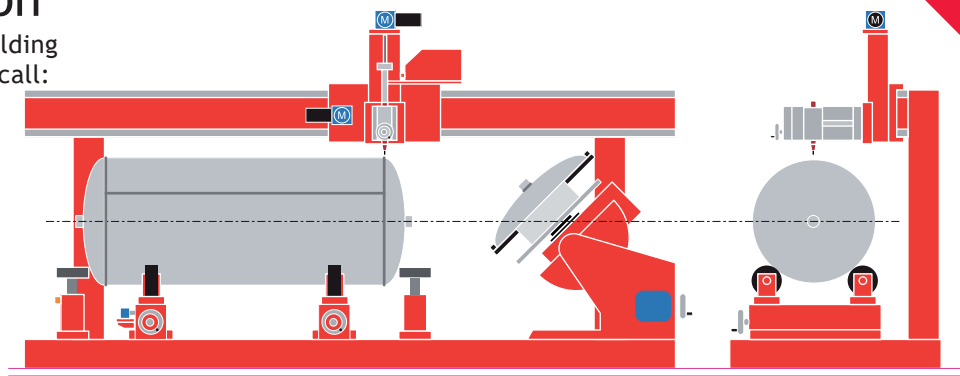

# Turnrollers

## Roller block series HGK up to 1000 t

### Stable turning

The HGK series has two synchronous drive units that provide continuous rotation with infinitely variable speed control. The distance between the rollers can be increased and decreased manually by means of bolts in order to achieve a large diameter range of the workpieces.

### Features

- For turning and positioning workpieces in the sections of mechanical engineering, container building, plant construction and pipeline construction.
- With two synchronous driven motors.
- Adjustable rotating speed.
- PU-Rolls.
- The adjustment is via bolts
- Remote control

Scope of delivery:  
1 Remote control

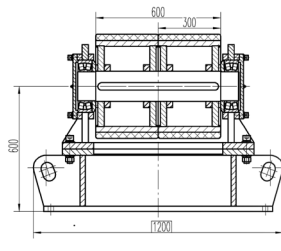
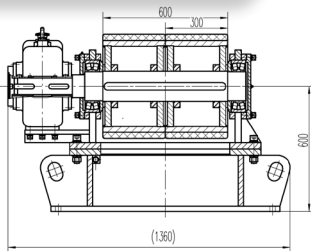
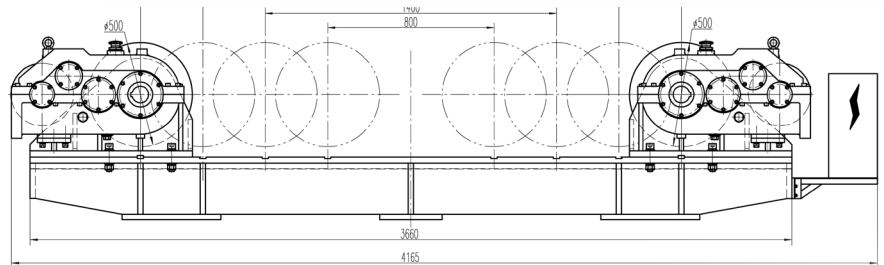
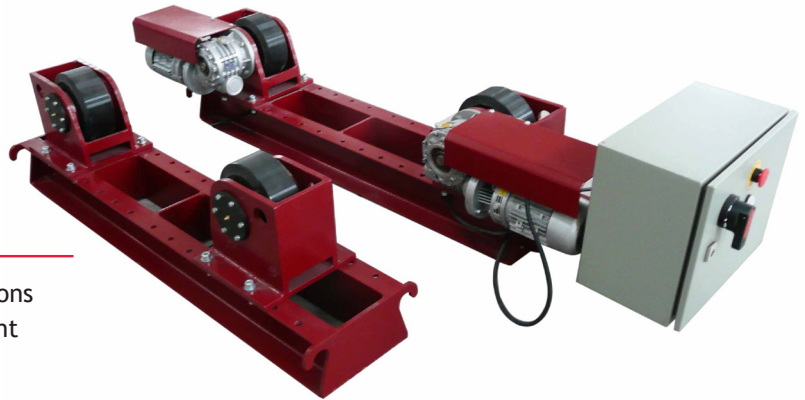

The HGK-Series:  
For Workpiece diameter  
from 250 mm up to 8.000 mm

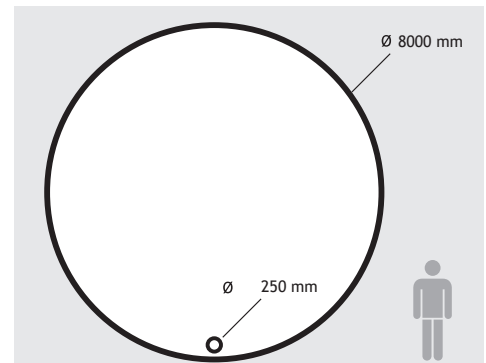

HGK-150

Model	Speed	Max. Load	Workpiece diameter	Motor (Kw) Power	rubber diameter	rubber rollers width	Item no.
HGK-5		5.000 kg	250 – 2.800 mm	2 x 0,37	250 mm	120 mm	02.20.10.10150
HGK-10		10.000 kg	300 – 3.200 mm	2 x 0,55	300 mm	130 mm	02.20.10.11100
HGK-20		20.000 kg	500 – 4.500 mm	2 x 1,1	350 mm	180 mm	02.20.10.11200
HGK-40		40.000 kg	500 – 5.000 mm	2 x 1,5	400 mm	220 mm	02.20.10.11400
HGK-60	6 - 60 m/h	60.000 kg	800 – 6.000 mm	2 x 2,2	450 mm	2x 180 mm	02.20.10.11600
HGK-80		80.000 kg	800 – 6.000 mm	2 x 3	450 mm	2x 180 mm	02.20.10.11800
HGK-100		100.000 kg	800 – 6.000 mm	2 x 3	500 mm	2x 200 mm	02.20.10.12000
HGK-160		160.000 kg	800 – 6.000 mm	2 x 4	550 mm	200 mm	
HGK-200		200.000 kg	800 – 6.500 mm	2 x 4	650 mm	250 mm	
HGK-250		250.000 kg	800 – 6.500 mm	2 x 5,5	650 mm	250 mm	
HGK-300		300.000 kg	800 – 6.500 mm	2 x 5,5	700 mm	300 mm	
HGK-500		500.000 kg	1.000 – 8.000 mm	2 x 7,5	750 mm	350 mm	
HGK-800		800.000 kg	1.000 – 8.000 mm	2 x 15	850 mm	400 mm	
HGK-1000		1.000 000 kg	1.000 – 8.000 mm	2 x 18,5	900 mm	500 mm	



# Turnrollers

## Roller block HGZT with 2 AC-Motoren to 150 t

### Self-centring

The HGZT series has two synchronously operating drive units that provide continuous rotation with infinitely variable speed control. The roller spacing is self-centring and the rollers align with the diameter of the workpiece.



### Features

- For turning and positioning workpieces in the sections of mechanical engineering, container building, plant construction and pipeline construction.
- With 2 AC motors
- Self centring wheel distance
- Automatic adaptation to the workpiece for different diameters
- With two synchronous driven motors.
- Adjustable rotating speed.
- PU-Rolls.
- The adustment is via bolts
- Remote control

Scope of delivery:  
1 Remote control

Model	Speed	Max. Load	Workpiece diameter	Motor (Kw) Power	rubber diameter	rubber rollers width	Item no.
HGZT-5	6 - 60 m/h	5.000 kg	250 – 2.500 mm	2x0,37	250 mm	100 mm	02.20.10.20150
HGZT-10		10.000 kg	320 – 3.200 mm	2x0,55	300 mm	120 mm	02.20.10.20100
HGZT-20		20.000 kg	500 – 3.800 mm	2x1,1	350 mm	150 mm	02.20.10.20200
HGZT-40		40.000 kg	600 – 4.500 mm	2x1,5	400 mm	160 mm	02.20.10.20400
HGZT-60		60.000 kg	750 – 5.000 mm	2x2,2	450 mm	180 mm	02.20.10.20400
HGZT-80		80.000 kg	850 – 5.500 mm	2x3	450 mm	240 mm	
HGZT-100		100.000 kg	1.000 – 6.300 mm	2x3	500 mm	240 mm	
HGZT-150		150.000 kg	1.000 – 6.300 mm	2x4	500 mm	300 mm	

# Pipe Processing Unit

## Rotator RW1T

**Also  
available  
with  
PLC**



**Scope of delivery:**

- 1 Control (integrated)
- 1 Cable remote control

**Optional:**

- 1 Idler
- 1 m rail

# Pipe Processing Unit

## Rotator RW1T

### Features

- Compact and sturdy design
- For welding, cutting and grinding
- A wide range of pipes can be processed  
Even pipe elbows or flanges are no problem
- Clamping without chuck
- lap-welding possible

Model	RW1T
Supply voltage	AC 230 V/50 Hz
Max. Load	2.000 kg
Workpiece diameter	50 – 400 mm
Min. workpiece length	450 mm
Rotation speed	200 – 2.000 mm/min.
Torch stroke, vertical	100 mm
Torch stroke, horizontal	200 mm
Speed control	Inverter
Item no.	02.30.21.00010

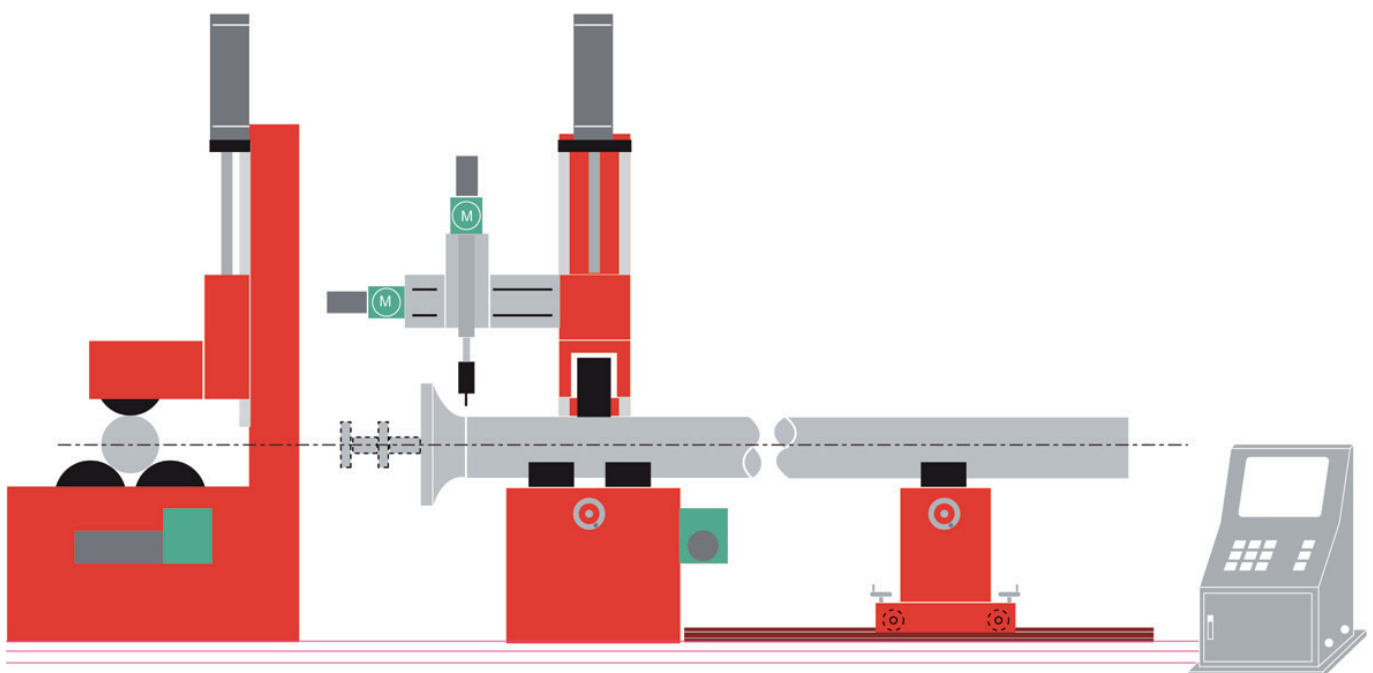

# Pipe Processing Unit

## GK-200 and GK-400

### Features

- Stable and compact construction.
- Welding, cutting and grinding possible.
- Clamping of a multitude of pipes. Also suitable for tube bends and pipes with flange.
- Fast and precise clamping without jaw chucks.

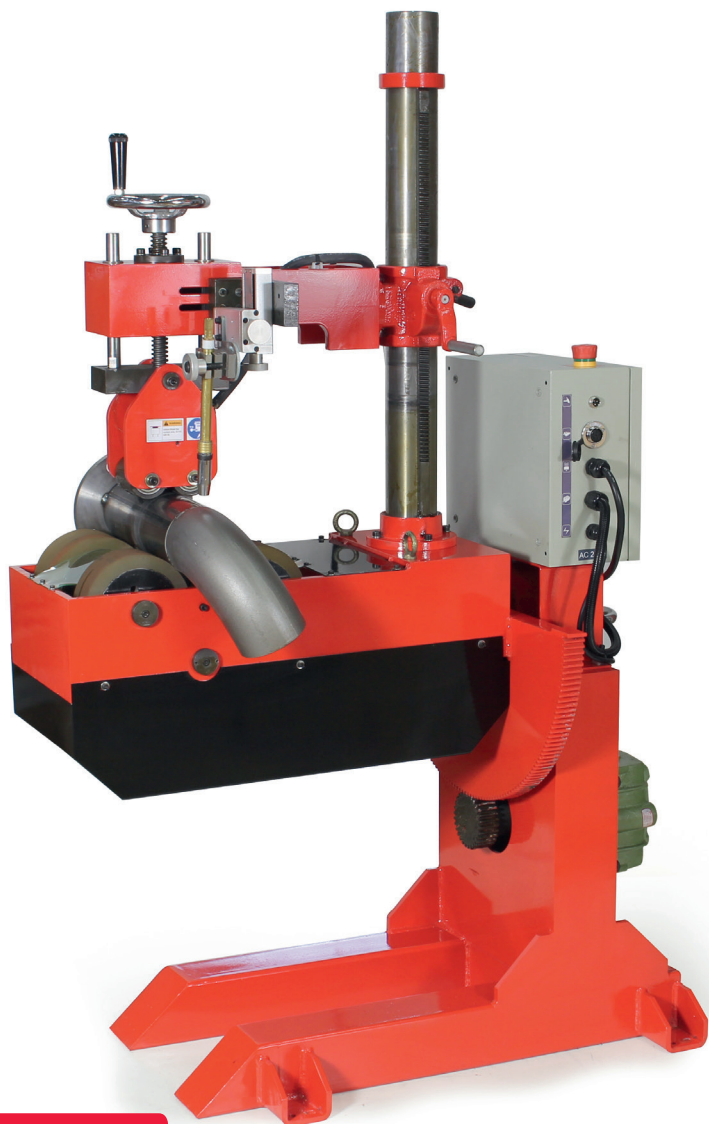
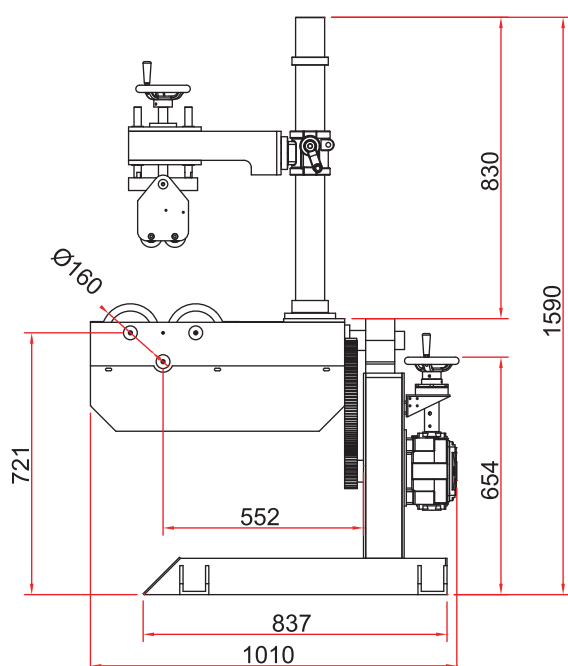

Model	GK-200	GK-400
Supply voltage	AC 230 V/50 Hz	3-phasig AC 380 V/50 Hz
Max. Load	200 kg	800 kg
Workpiece diameter	60 - 300 mm	60 - 400 mm
Workpiece length	over 400 mm	over 480 mm
Speed	190 ~ 1900 mm/min.	120 ~ 1200 mm/min.
Torque	109.8 Nm	600 Nm
Tilting moment	1,516.0 Nm	1,880 Nm
Tilting range	+ / - 80°	+ / - 45°
Tilting centre height	720 mm	820 mm
Speed adjustment	Inverter	
Power	100 W	DC 400 W
Size (L x B x H) mm	1010 x 646 x 1590	
Weight		
Item no.	02.30.20.00100	

### Scope of delivery:

- 1 Control (integrated)
- 1 Cable remote control

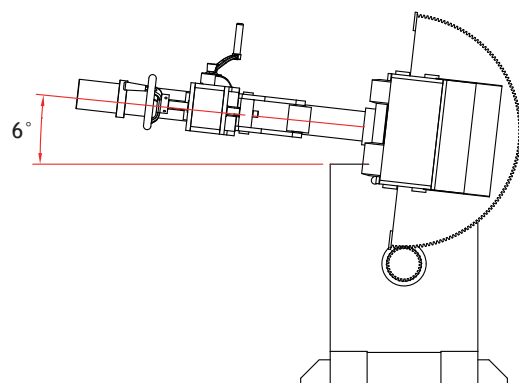



# Pipe Processing Unit

## GK-600 and GK-1000

Model	GK-600	GK-1000
Supply voltage	380 V, $\pm 10\%$ , 50 Hz	380 V, $\pm 10\%$ , 50 Hz
Max. Load	2 t	3 t
Workpiece diameter	60 – 600 mm	160 – 1000 mm
Speed	200 – 1000 mm/min.	200 – 1000 mm/min.
Torque	1.000 Nm	345 Nm
Tilting range	45°	45°
Tilting centre height	910 mm	714 mm
Speed adjustment	Inverter	Inverter
Power	1,1 Kw	1,1 Kw
Size (LxBxH) mm	2030x920x2630	2700x1960x1200
Weight	1.600 kg	2.000 kg
Item no.	02.30.20.00160 (old: 71860220)	02.30.20.00200 (old: 71860230)

### Features

- Stable and compact construction.
- Welding, cutting and grinding possible.
- Clamping of a multitude of pipes. Also suitable for tube bends and pipes with flange.
- Fast and precise clamping without jaw chucks.

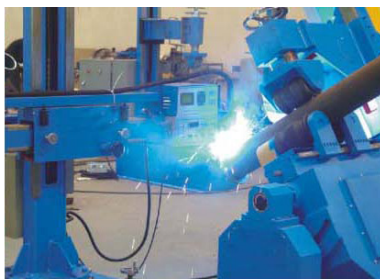

**Scope of delivery:**  
1 Control (integrated)  
1 Cable remote control

GK-1000 (pic. similar)

# Pipe Processing Unit

## PNR-500

Simple and flexible solutions from 100 mm to 2,500 mm:

The roller stands with clamping device are inexpensive and can be installed easily and quickly. A turntable can then be dispensed with here.

We will be happy to advise you.

Model	PNR-500
Power	AC 220V / 1Ø
Max. Load	500 kg
Workpiece diameter	19 - 410 mm
Rollers	50 mm
Speed	120 - 1200 mm / min
Direction of rotation	Rechts / Links
Start	Footswitch (inch/hold)
Arc way of the welder	<input type="checkbox"/> standard (2-cycle)
Item no.	02.31.20.10010

